



Sheraton®

HONG KONG
HOTEL & TOWERS



LEVEL 3 ROOM DIMENSIONS AND SEATING CAPACITY

	ROOM SIZE (L X W)	CEILING HEIGHT	AREA	ROUNDS OF 10	THEATRE	CONFERENCE (BOARDROOM)	RECEPTION	CLASSROOM 3 PER 6	U-SHAPE	EXHIBIT BOOTHS 8 X 10
	FEET METERS	FEET METERS	SQ.FT SQ.M							
GRAND BALLROOM	120'3" X 43'9" 36.7 X 13.3	7'6"-15'2" 2.3-4.6	5360 498	400	600	147	500	360	129	35
BALLROOM A	24'9" X 32'8" 7.5 X 10.0	7'6"-8'11" 2.3-2.7	839 78	40	72	36	30	36	24	5
BALLROOM B	45'7" X 32'8" 13.9 X 10.0	15'2"-16'9" 4.6-5.1	2024 188	90	176	54	80	84	42	11
BALLROOM C	50' X 43'9" 15.2 X 13.3	15'2"-16'9" 4.6-5.1	2217 206	120	252	66	100	108	48	13
BALLROOM AB	70'3" X 32'8" 21.4 X 10.0	7'6"-15'2" 2.3-4.6	3143 292	150	296	78	130	144	66	17
BALLROOM BC	95'7" X 43'9" 29.1 X 13.3	15'2"-16'9" 4.6-5.1	4521 420	220	500	102	420	261	84	28
PREFUNCTION AREA	153'2" X 30'7" 46.7 X 9.4	7'6"-7'10" 2.3-2.4	2755 256	40	-	-	100	-	-	-
TANG	64'5" X 28'6" 19.6 X 8.7	7'5"-7'9" 2.3-2.4	1687 157	90	170	38	80	78	29	8
TANG I	28'10" X 28'6" 8.8 X 8.7	7'5"-7'9" 2.3-2.4	786 73	50	65	38	40	36	29	4
TANG II	35'8" X 28'6" 10.9 X 8.7	7'5"-7'9" 2.3-2.4	1001 93	30	50	26	30	24	20	3
SECRETARIAL 1	18'7" X 23'6" 5.7 X 7.2	7'-7" 2.1-2.1	344 32	-	-	-	-	-	-	-
SECRETARIAL 2	14'1" X 31'10" 4.3 X 9.7	7'-7" 2.1-2.1	355 33	-	-	-	-	-	-	-

*All figures are for reference only. For exact figures, on-site measurement is recommended. # Usage of HD LED display wall is subject to additional charges.

SHERATON HONG KONG
HOTEL & TOWERS
20 Nathan Road
Kowloon, Hong Kong
T 852 2369 1111
F 852 2739 8707
sheraton.com/hongkong
sheratonhongkonghotel.com

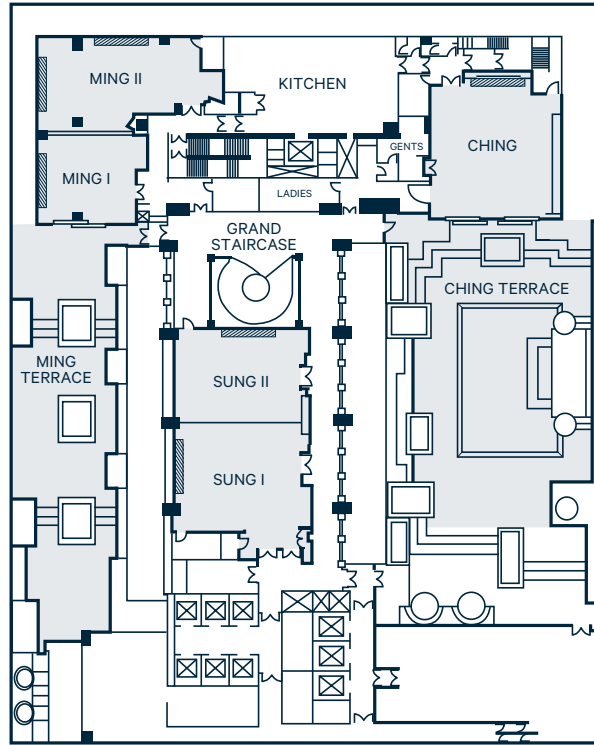

LEVEL 4 ROOM DIMENSIONS AND SEATING CAPACITY

	ROOM SIZE (L X W)	CEILING HEIGHT	AREA	ROUNDS OF 10	THEATRE	CONFERENCE (BOARDROOM)	RECEPTION	CLASSROOM 3 PER 6	U-SHAPE	EXHIBIT BOOTHS 8 X 10
	FEET METERS	FEET METERS	SQ.FT SQ.M							
SUNG	62'8" X 40'2" 19.1 X 12.2	7'-7'10" 2.1-2.4	2077 193	140	200	60	100	96	51	11
SUNG I	38' X 40'2" 11.6 X 12.2	7'-7'10" 2.1-2.4	1205 112	50	100	42	60	60	33	6
SUNG II	24'7" X 40'2" 7.5 X 12.2	7'-7'10" 2.1-2.4	872 81	30	80	30	40	36	21	3
MING	53'6" X 52'2" 16.3 X 15.9	7'5"-7'8" 2.3-2.3	1797 167	90	140	34	90	63	29	8
MING I	31'6" X 24'5" 9.6 X 7.4	7'5"-7'8" 2.3-2.3	689 64	30	40	26	30	18	20	2
MING II	53'6" X 27'9" 16.3 X 8.5	7'5"-7'8" 2.3-2.3	1109 103	60	100	34	60	51	29	6
MING TERRACE	41'9" X 114'6" 12.7 X 34.9	-	3132 291	-	-	-	50	-	-	-
CHING	36'5" X 40'9" 11.1 X 12.4	7'8"-7'10" 2.3-2.4	1367 127	70	126	48	80	60	36	5
CHING TERRACE	56'7" X 75'1" 17.2 X 22.9	-	3078 286	-	-	-	100	-	-	-

*All figures are for reference only. For exact figures, on-site measurement is recommended.